

Straight Talk from 3D CAD Users

Hear what designers are saying about Pro/ENGINEER®



DID YOU KNOW

"My design productivity definitely increases when my 3D CAD software tools run smoothly without interruption...and this is why Pro/ENGINEER is the best choice for my business."

Mike Ahrens, from San Jose, California, has more than 13 years of experience in mechanical engineering and machine design. Having worked for a variety of companies in different industries, he was able to become familiar with many aspects of product design—and with various CAD packages, including SolidWorks® and AutoCAD®.

"My first experience with Pro/ENGINEER was when I worked in the aerospace industry in 1996. As a Satellite Manufacturing Engineer, my job was to ensure that Pro/ENGINEER 3D models were machined accurately. The learning curve was about two weeks to gain the basic knowledge necessary to satisfy my job function at the time. After that, hands-on experience and learning tips and tricks from colleagues proved most valuable.

A few years later, I worked for a small machine shop to develop 'pick and place' machines for the medical industry. At this job, training was hands-on, and I was introduced to [PTC's] Pro/Manufacture for direct CNC machining from the 3D models I had created. Seeing new designs hitting the production floor in record time was eye opening, and further solidified my respect for Pro/ENGINEER as a whole.

In another job engagement, my main focus was on large assembly creation. I've found that other CAD tools, such as SolidWorks, have a tendency to bog down, hang, and/or crash when loading larger assemblies. It's frustrating, as a user, when multiple Service Packs must be installed to keep new software revisions stable."



Mike Ahrens
Mechanical Engineer & Owner
Ahrens Bicycles
San Jose, California, USA

Why Pro/ENGINEER is So Effective

"Being a devoted mountain biker, I founded Ahrens Bicycles in the late 1990s. At Ahrens Bicycles, I custom-build high-quality frames for other bike enthusiasts. Especially for small shops like mine, Pro/ENGINEER is the best solution, since it is not only affordable, but provides the most powerful set of functionality for a low price.

Pro/ENGINEER provides a stable platform for developing highly accurate 3D models and fabrication drawings. I can count on Pro/ENGINEER to run smoothly when I'm designing new frames, welding fixtures, or any other idea that comes to mind. Pro/ENGINEER is a unique and powerful software suite that enables rapid realization of new concepts. The ability to easily modify and manipulate 3D models is extremely valuable to design engineers.

Pro/ENGINEER has enabled me to create 'master models' of specific bicycle frame types (mountain, road, cyclo-cross, track, commuter, etc.) that can be easily tweaked based on a rider's physical size, riding style, wheel size, and desired performance characteristics. With this level of flexibility, new frame designs can be created and verified quickly, while minimizing production hiccups. I believe this capability separates my company from other boutique frame builders operating in the same space."



Apex hardtail mountain bike frame designed using Pro/ENGINEER.

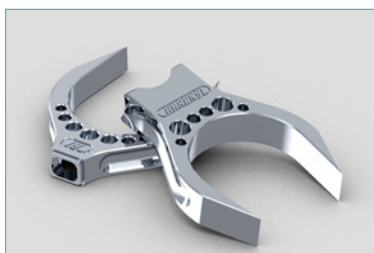

Apex rear triangle yokes designed using Pro/ENGINEER.